

# Pistol Barrel & Cylinder Fixture *INSTRUCTIONS*

First, position the Center Support (A) so that equal amounts protrude both sides of the Center Mount Block (B)...see ILL. 1 Hold the pistol barrel or cylinder against the center support cone and guesstimate the placement needed for the Fixed Mount Block (C). Count the holes required between them and secure the Fixed Mount Block.

As you tighten the barrel or cylinder it will compress the rubber spacer behind the fixed center support to create rotational friction. Tighten until the desired rotational friction is achieved. Then lock in position by tightening the center support lock bolt (D).

Place the fixture base in the jaws of a ball vise so that the center of rotation is where you are working. A positioning vise (ILL. 2) allows you to shift the "center" without removing fixture from the vise.

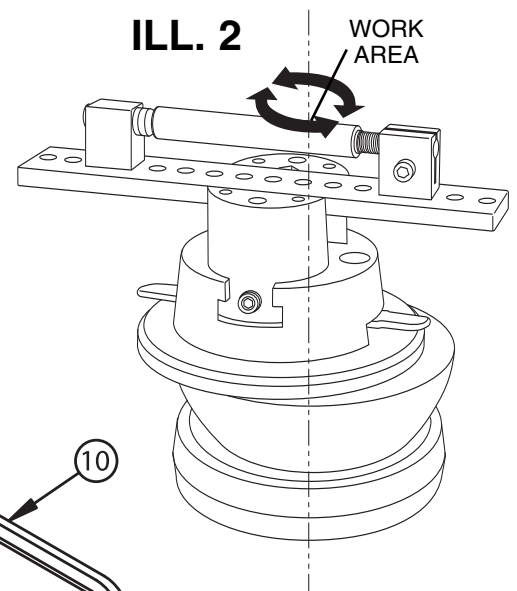
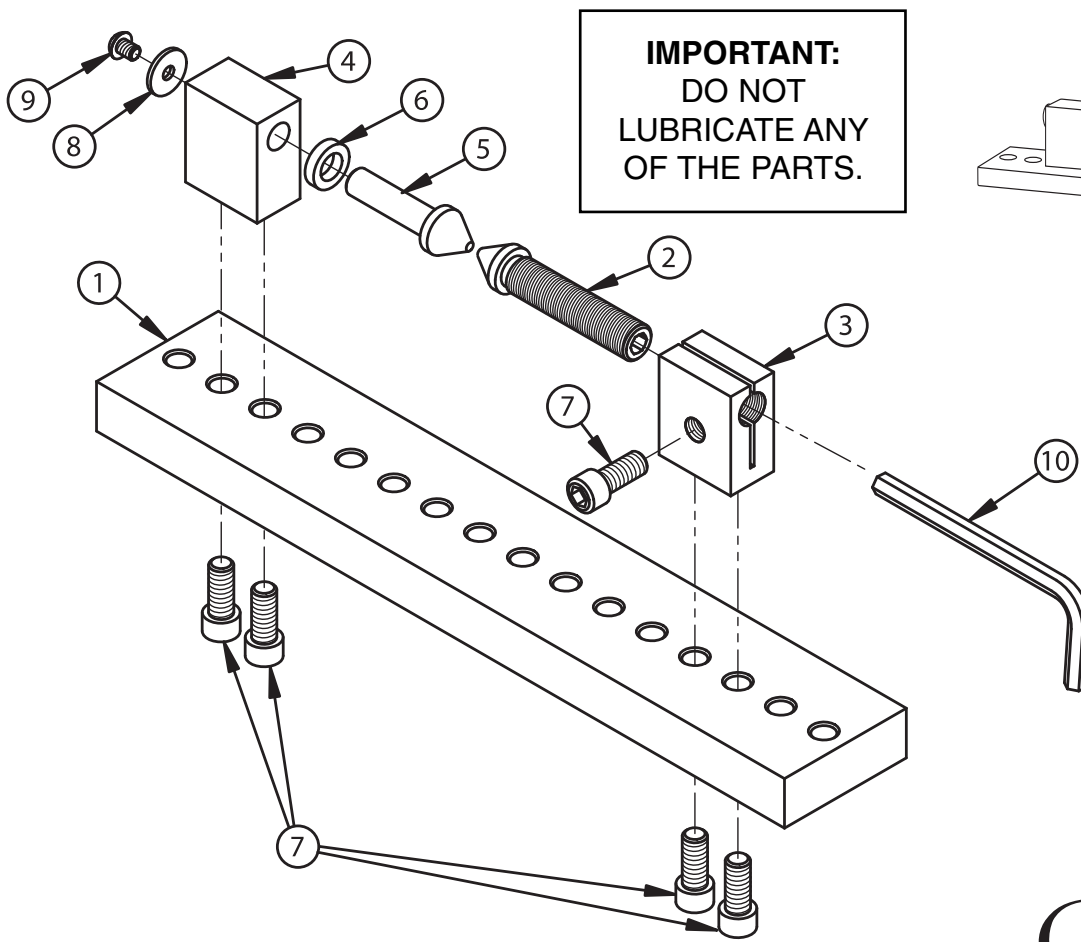
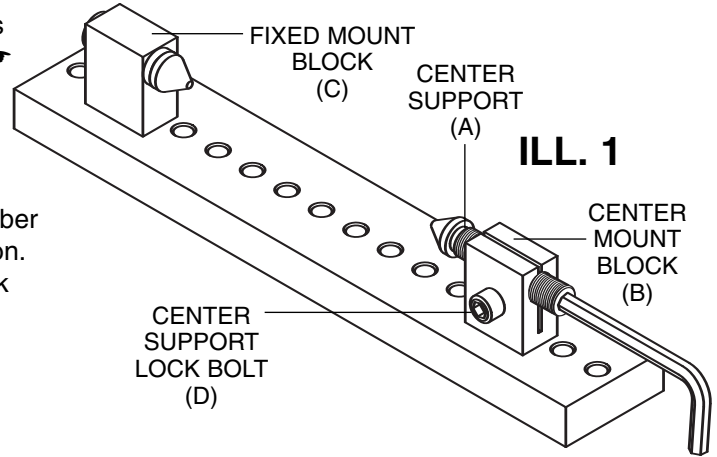

**NOTE:** If you work totally on short barrels, you may find it handier to shorten the base bar.

## #003-643 PISTOL BARREL FIXTURE PARTS LIST

1	#003-266	Base Bar
2	#003-267	Center Support - Moveable
3	#003-269	Center Mount - Moveable
4	#003-270	Center Mount - Fixed
5	#003-268	Center Support - Fixed
6	#003-271	Rubber Spacer
7	#002-750	5/16-18 X .75" SHCS
8	#002-247	.191 X .628 X 16 Gauge Washer
9	#022-553	#10-32 X 1/4" RHMS
10	#002-751	1/4" Short Arm Hex Wrench



900 Overlander Road  
Emporia, KS 66801 USA

Toll Free: 1-800-835-3519  
Fax: 620-343-9640  
Tel: 620-343-1084  
e-mail: GRS@GrsTools.com

[www.GrsTools.com](http://www.GrsTools.com)

LIT #183